

Wall mounted receptacle

Part no. 75276



- switched
- electrical interlock
- seawater resistant design available on request

Technical specifications

Ampere	200 A
Poles	5 p
Voltage	400 V
Clock position	6 h
Hertz	50-60 Hz
Connection technology	Screw terminals
Contact	standard
Protection type	IP 55
Weight	23000 g

Drawing

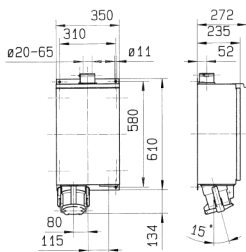

Drawing
1 MB 387
Dim. in mm