

## Wall mounted receptacle

Part no. 24315



- screw terminals
- X-CONTACT®
- highly heat resistant contact carrier
- nickel plated contacts
- products with pilot contact: part no. + index P

## Technical specifications

|                       |   |
|-----------------------|---|
| Ampere                | 63 A  |
| Poles                 | 4 p   |
| Voltage               | 400 V   |
| Clock position        | 6 h   |
| Hertz                 | 50-60 Hz  |
| Connection technology | Screw terminals   |
| Contact               | highly heat resistant contact carrier, nickel plated contacts, X-CONTACT® |
| Protection type       | IP 67   |
| Weight                | 930 g   |

## Drawing

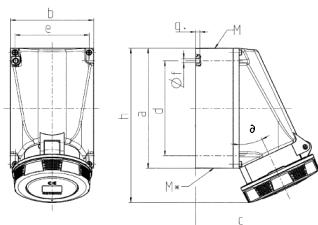

| Drawing<br>1 MB 112/162 | Amp.<br>Poles   | 63                         |       |       | 125 |     |
|-------------------------|---|----------------------------|-------|-------|-----|-----|
|                         |   | 3                          | 4     | 5     | 4   | 5   |
| Dim. in mm              | a   | 170                        | 170   | 170   | 264 | 264 |
|                         | b   | 118                        | 118   | 118   | 163 | 163 |
|                         | c   | 175                        | 175   | 175   | 200 | 200 |
|                         | d   | 134.5                      | 134.5 | 134.5 | 240 | 240 |
|                         | e   | 103                        | 103   | 103   | 140 | 140 |
|                         | f   | 6.1                        | 6.1   | 6.1   | 8.1 | 8.1 |
|                         | g   | 6                          | 6     | 6     | 8   | 8   |
|                         | h   | 219                        | 219   | 219   | 306 | 306 |
|                         | M   | 40                         | 40    | 40    | 50  | 50  |
|                         | M*  | 2x40 (blind) to be cut out |       |       | 50  | 50  |
|                         | ø   | 25                         | 25    | 25    | 20  | 20  |
|                         | Max. cable diam. (mm)   | 27                         | 27    | 27    | 38  | 38  |
|                         | Terminal for cond. cross section (mm <sup>2</sup> ) min.-max. | 6                          | 6     | 6     | 25  | 25  |
|                         |   | -25                        | -25   | -25   | -35 | -35 |