

Panel mounted receptacle

Part no. 208A



- screw terminals
- X-CONTACT®
- 20° inclination
- receptacles with pilot contact: part no. + index P

Technical specifications

| | |
|---------------------------|------------------|
| Ampere | 63 A |
| Poles | 5 p |
| Voltage | 230 V |
| Clock position | 9 h |
| Hertz | 50-60 Hz |
| Connection technology | Screw terminals |
| Contact | X-CONTACT® |
| Protection type | IP 67 |
| Flange | 110x106 mm |
| Fixing hole | 85x77 mm |
| Inclination | 20 ° |
| Weight | 668 g |
| Declaration of Conformity | DE, VDE, CN, CQC |

Drawing

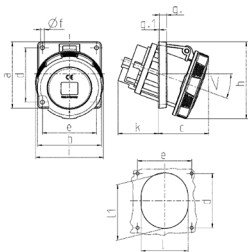

| 1 MB 298 1 MB 601 Dim. in mm | Amp. Poles | 63 | | | 125 | | |
|---|---------------|-----|-----|-----|-----|-----|-----|
| | | 3 | 4 | 5 | 3 | 4 | 5 |
| a | | 110 | 110 | 110 | 114 | 114 | 114 |
| b | | 106 | 106 | 106 | 110 | 110 | 110 |
| c | | 85 | 85 | 85 | 75 | 75 | 75 |
| d | | 85 | 85 | 85 | 90 | 90 | 90 |
| e | | 77 | 77 | 77 | 90 | 90 | 90 |
| f | | 6.2 | 6.2 | 6.2 | 6.2 | 6.2 | 6.2 |
| g | | 12 | 12 | 12 | 13 | 13 | 13 |
| g.1 | | 2 | 2 | 2 | 2 | 2 | 2 |
| h | | 128 | 128 | 128 | 133 | 133 | 133 |
| i | | 113 | 113 | 113 | 126 | 126 | 126 |
| k | | 67 | 67 | 67 | 103 | 103 | 103 |
| l | | 92 | 92 | 92 | 94 | 94 | 94 |
| l1 | | 98 | 98 | 98 | 107 | 107 | 107 |
| < | | 20° | 20° | 20° | 15° | 15° | 15° |
| Terminal for cond. cross section (mm²) min.-max. | | 6 | 6 | 6 | 25 | 25 | 25 |
| | | -25 | -25 | -25 | 70 | 70 | 70 |