

Wall mounted receptacle

Part no. 75116



- screw terminals
- external fixing
- cable entry at top
- with cable gland
- seawater resistant products are available on request

Technical specifications

Ampere	400 A
Poles	5 p
Voltage	400 V
Clock position	6 h
Hertz	60-50 Hz
Connection technology	Screw terminals
Contact	standard
Protection type	IP 67
Weight	11000 g

Drawing

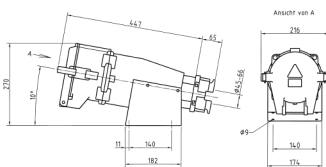

Drawing
1 MB 389/1
Dim. in mm