

Panel mounted phase inverter inlet

Part no. 913



- screw terminals

Technical specifications

| | |
|---------------------------|-----------------|
| Ampere | 32 A |
| Poles | 5 p |
| Voltage | 230 V |
| Clock position | 9 h |
| Hertz | 50-60 Hz |
| Connection technology | Screw terminals |
| Contact | standard |
| Protection type | IP 44 |
| Weight | 258 g |
| Declaration of Conformity | DE, VDE |

Drawing

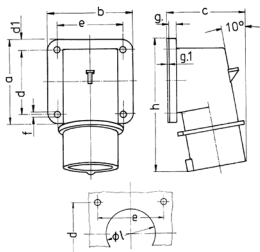

| Drawing 2 MB 73 | Amp. Poles | 16 | | 32 | | |
|--|---------------|------|------|-----|-----|-----|
| | | 4 | 5 | 3 | 4 | 5 |
| Dim. in mm | a | 85 | 85 | 75 | 75 | 75 |
| | b | 85 | 85 | 90 | 90 | 90 |
| | c | 75 | 79 | 87 | 87 | 90 |
| | d | 64 | 64 | 45 | 45 | 45 |
| | d1 | 10 | 10 | 13 | 13 | 13 |
| | e | 64 | 64 | 78 | 78 | 78 |
| | f | 5.5 | 5.5 | 5.5 | 5.5 | 5.5 |
| | g | 6 | 6 | 6 | 6 | 6 |
| | g.1 | 2 | 2 | 2 | 2 | 2 |
| | h | 129 | 129 | 137 | 137 | 138 |
| | l | 50 | 50 | 55 | 55 | 55 |
| Terminal for cond. cross section (mm ²) min.-max. | | 1 | 1 | 2.5 | 2.5 | 2.5 |
| | | -2.5 | -2.5 | -6 | -6 | -6 |