

## Panel mounted receptacle

Part no. 212A



- screw terminals
- X-CONTACT®
- 15° inclination
- receptacles with pilot contact: part no. + index P

## Technical specifications

|                           |                 |
|---------------------------|-----------------|
| Ampere                    | 125 A           |
| Poles                     | 4 p             |
| Voltage                   | 400 V           |
| Clock position            | 6 h             |
| Hertz                     | 50-60 Hz        |
| Connection technology     | Screw terminals |
| Contact                   | X-CONTACT®      |
| Protection type           | IP 67           |
| Flange                    | 114x110 mm      |
| Fixing hole               | 90x90 mm        |
| Inclination               | 15 °            |
| Weight                    | 940 g           |
| Declaration of Conformity | VDE, EAC, CQC   |

## Drawing

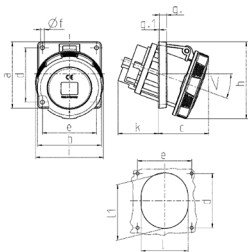

| 1 MB 298<br>1 MB 601<br>Dim. in mm               | Amp.<br>Poles | 63  |     |     | 125 |     |     |
|--|---------------|-----|-----|-----|-----|-----|-----|
|  |               | 3   | 4   | 5   | 3   | 4   | 5   |
| a  |               | 110 | 110 | 110 | 114 | 114 | 114 |
| b  |               | 106 | 106 | 106 | 110 | 110 | 110 |
| c  |               | 85  | 85  | 85  | 75  | 75  | 75  |
| d  |               | 85  | 85  | 85  | 90  | 90  | 90  |
| e  |               | 77  | 77  | 77  | 90  | 90  | 90  |
| f  |               | 6.2 | 6.2 | 6.2 | 6.2 | 6.2 | 6.2 |
| g  |               | 12  | 12  | 12  | 13  | 13  | 13  |
| g.1  |               | 2   | 2   | 2   | 2   | 2   | 2   |
| h  |               | 128 | 128 | 128 | 133 | 133 | 133 |
| i  |               | 113 | 113 | 113 | 126 | 126 | 126 |
| k  |               | 67  | 67  | 67  | 103 | 103 | 103 |
| l  |               | 92  | 92  | 92  | 94  | 94  | 94  |
| l1   |               | 98  | 98  | 98  | 107 | 107 | 107 |
| <  |               | 20° | 20° | 20° | 15° | 15° | 15° |
| Terminal for cond. cross section (mm²) min.-max. |               | 6   | 6   | 6   | 25  | 25  | 25  |
|  |               | -25 | -25 | -25 | 70  | 70  | 70  |