

Panel mounted receptacle TM

Part no. 22189A



- screw terminals
- highly heat resistant contact carrier
- nickel plated contacts
- 15° inclination
- (form BS)

Technical specifications

Ampere	125 A
Poles	5 p
Voltage	400 V
Clock position	6 h
Hertz	50-60 Hz
Connection technology	Screw terminals
Contact	highly heat resistant contact carrier, nickel plated contacts, X-CONTACT®
Protection type	IP 67
Flange	114x110 mm
Fixing hole	90x90 mm
Inclination	15 °
Weight	1232 g
Declaration of Conformity	VDE, EAC

Drawing

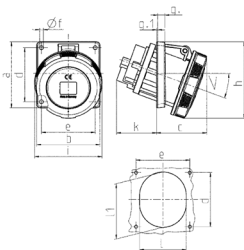

Drawing 1 MB 601	Amp. Poles	63				125			
		5	3	4	5				
Dim. in mm	a	110	114	114	114				
	b	106	110	110	110				
	c	84	75	75	75				
	d	90	90	90	90				
	e	90	90	90	90				
	f	6.5	6.2	6.2	6.2				
	g	12	13	13	13				
	g.1	2	2	2	2				
	h	128	133	133	133				
	i	113	126	126	126				
	k	67	103	103	103				
	l	92	94	94	94				
	lt	98	107	107	107				
	<	15°	15°	15°	15°				
Terminal for cond. cross section (mm²) min.-max.		6	25	25	25				
		-20	-70	-70	-70				