

## Panel mounted receptacle TM

Part no. 23163



- screw terminals
- highly heat resistant contact carrier
- nickel plated contacts
- straight
- (form AS)

## Technical specifications

Ampere	16 A
Poles	5 p
Voltage	440-460 V
Clock position	11 h
Hertz	60 Hz
Connection technology	Screw terminals
Contact	highly heat resistant contact carrier, nickel plated contacts
Protection type	IP 67
Flange	75x75 mm
Fixing hole	60x60 mm
Weight	236 g
Declaration of Conformity	VDE, EAC

## Drawing

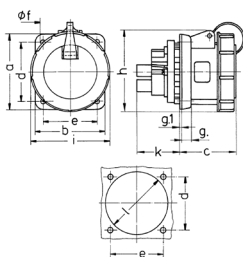

Drawing 1 MB 217/1	Amp. Poles	16		32		63	
		3	5	3	5	5	
Dim. in mm	a	75	75	85	85	107	107
	b	75	75	75	75	100	100
	c	60	60	67	73	82	82
	d	60	60	60	60	85	85
	e	60	60	60	60	77	77
	f	5.5	5.5	5.5	5.5	6.5	6.5
	g	8	8	8	8	12	12
	g-1	2	2	2	2	2	2
	h	81	95	95	106	115	115
	i	70	88	94	102	114	114
	k	26	27	34	34	55	55
	l	52	57	58	65	88	88
Terminal for cond. cross section (mm <sup>2</sup> ) min.-max.		1.5	1.5	2.5	2.5	6	6
		-4	-4	-10	-10	-25	-25