

## Wall mounted receptacle

Part no. 2676A



- screw terminals
- internal fixing
- one cable entry at top and one blind entry (can be cut out) at the bottom
- enclosure base can be turned 180°

## Technical specifications

Ampere	32 A
Poles	5 p
Voltage	50-500 V
Clock position	1 h
Connection technology	Screw terminals
Contact	standard
Protection type	IP 44
Weight	405 g
Declaration of Conformity	VDE, EAC, CQC

## Drawing

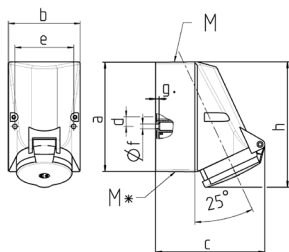

Drawing	Amp.	16		32		
		Poles		3	4	5
1 MB 43						
Dim. in mm						
a		128	128	128	128	128
b		84	84	84	84	84
c		122	124	136	136	138
d		11	11	11	11	11
e		68	68	68	68	68
f		5.3	5.3	5.3	5.3	5.3
g		4	4	4	4	4
h		144	145	158	158	160
M		25	25	32	32	32
M*		2x25 (blind) to be cut out		2x25 (blind) to be cut out		
Max. cable diam. (mm)		18	18	18/25	18/25	18/25
Terminal for cond. cross section (mm <sup>2</sup> ) min.-max.		1.5	1.5	2.5	2.5	2.5
		-4	-4	-10	-10	-10