

Receptacle

Part no. 2767A



- screw terminals
- internal fixing
- one cable entry at top and two blind entries (can be cut out) at the bottom
- enclosure base can be turned 180°

Technical specifications

| | |
|---------------------------|-----------------|
| Ampere | 32 A |
| Poles | 5 p |
| Voltage | 600-690 V |
| Clock position | 5 h |
| Hertz | 50-60 Hz |
| Connection technology | Screw terminals |
| Contact | standard |
| Protection type | IP 44 |
| Weight | 395 g |
| Declaration of Conformity | VDE, EAC, CQC |

Drawing

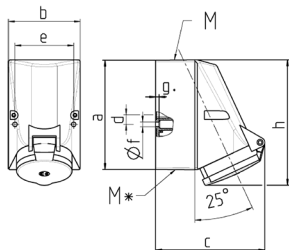

| Drawing 1 MB 43 | Amp. Poles | 16 | | 32 | | |
|--------------------|---|----------------------------|-----|----------------------------|-------|-------|
| | | 4 | 5 | 3 | 4 | 5 |
| Dim. in mm | a | 128 | 128 | 128 | 128 | 128 |
| | b | 84 | 84 | 84 | 84 | 84 |
| | c | 122 | 124 | 136 | 136 | 138 |
| | d | 11 | 11 | 11 | 11 | 11 |
| | e | 68 | 68 | 68 | 68 | 68 |
| | f | 5.3 | 5.3 | 5.3 | 5.3 | 5.3 |
| | g | 4 | 4 | 4 | 4 | 4 |
| | h | 144 | 145 | 158 | 158 | 160 |
| | M | 25 | 25 | 32 | 32 | 32 |
| | M* | 2x25 (blind) to be cut out | | 2x25 (blind) to be cut out | | |
| | Max. cable diam. (mm) | 18 | 18 | 18/25 | 18/25 | 18/25 |
| | Terminal for cond. cross section (mm ²) min.-max. | 1.5 | 1.5 | 2.5 | 2.5 | 2.5 |
| | | -4 | -4 | -10 | -10 | -10 |