

Panel mounted receptacle

Part no. 2837



- screw terminals
- 20° inclination

Technical specifications

Ampere	32 A
Poles	3 p
Voltage	20-25, 40-50 V
Clock position	4 h
Hertz	100-200 Hz
Connection technology	Screw terminals
Contact	standard
Protection type	IP 44
Flange	100x92 mm
Fixing hole	85x77 mm
Inclination	20 °
Weight	170 g
Declaration of Conformity	EAC, CQC

Drawing

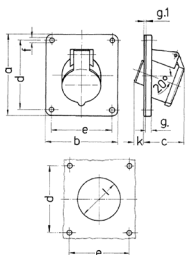

Drawing	Amp.	32
1 MB 236	Poles	3
Dim. in mm	a	100
	b	92
	c	42
	d	85
	e	77
	f	5,1
	g.	8
	g.1	2
	k	31
	l	60
Terminal for cond. cross section (mm ²) min.-max.		4 —10