

Panel mounted receptacles with TwinCONTACT

Part no. 3070



- screwless spring terminals
- standard flange dimensions
- 20° inclination
- receptacles are designed for adding an auxiliary contact switch

Technical specifications

| | |
|---------------------------|-------------------------|
| Ampere | 16 A |
| Poles | 5 p |
| Voltage | 400 V |
| Clock position | 6 h |
| Hertz | 50-60 Hz |
| Connection technology | Screwless - TwinCONTACT |
| Contact | standard |
| Protection type | IP 44 |
| Flange | 85x85 mm |
| Fixing hole | 70x70 mm |
| Inclination | 20 ° |
| Weight | 140 g |
| Declaration of Conformity | VDE, EAC |

Drawing

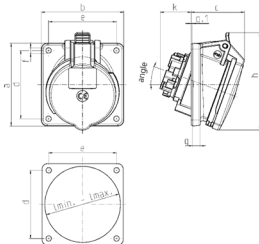

| Drawing 1 MB 519 | Amp. Poles | 16 | | | 32 | | |
|--|---------------|-----|-----|-----|-----|-----|-----|
| | | 3 | 4 | 5 | 3 | 4 | 5 |
| Dim. in mm | a | 85 | 85 | 85 | 85 | 85 | 85 |
| | b | 85 | 85 | 85 | 85 | 85 | 85 |
| | c | 52 | 57 | 55 | 61 | 60 | 66 |
| | d | 70 | 70 | 70 | 70 | 70 | 70 |
| | e | 70 | 70 | 70 | 70 | 70 | 70 |
| | f | 5.5 | 5.5 | 5.5 | 5.5 | 5.5 | 5.5 |
| | g | 8 | 8 | 8 | 8 | 8 | 8 |
| | g.1 | 2 | 2 | 2 | 2 | 2 | 2 |
| | h | 86 | 96 | 100 | 96 | 104 | 110 |
| | k | 31 | 32 | 33 | 43 | 44 | 48 |
| | l min. | 57 | 64 | 70 | 78 | 78 | 78 |
| | l max. | 76 | 76 | 76 | 78 | 78 | 78 |
| | ∅ | 20 | 20 | 20 | 20 | 20 | 20 |
| Terminal for cond. cross section (mm ²) min.-max. | | 1.5 | 1.5 | 1.5 | 2.5 | 2.5 | 2.5 |
| | | -4 | -4 | -4 | -10 | -10 | -10 |