

## Panel mounted receptacle

Part no. 3137



- standard flange
- dimensions 85 x 85 mm
- 20° inclination

## Technical specifications

|                           |                 |
|---------------------------|-----------------|
| Ampere                    | 32 A            |
| Poles                     | 3 p             |
| Voltage                   | 500 V           |
| Clock position            | 7 h             |
| Hertz                     | 50-60 Hz        |
| Connection technology     | Screw terminals |
| Contact                   | standard        |
| Protection type           | IP 44           |
| Flange                    | 85x85 mm        |
| Fixing hole               | 70x70 mm        |
| Inclination               | 20 °            |
| Weight                    | 236 g           |
| Declaration of Conformity | VDE, CQC        |

## Drawing

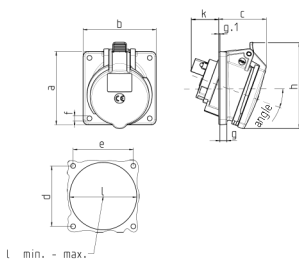

| Drawing<br>1 MB 453 | Amp.<br>Poles                                    | 16  |     |     | 32  |     |     |
|---------------------|--|-----|-----|-----|-----|-----|-----|
|                     |  | 3   | 4   | 5   | 3   | 4   | 5   |
| Dim. in mm          | a  | 85  | 85  | 85  | 85  | 85  | 85  |
|                     | b  | 85  | 85  | 85  | 85  | 85  | 85  |
|                     | c  | 53  | 57  | 57  | 60  | 60  | 67  |
|                     | d  | 70  | 70  | 70  | 70  | 70  | 70  |
|                     | e  | 70  | 70  | 70  | 70  | 70  | 70  |
|                     | f  | 5.5 | 5.5 | 5.5 | 5.5 | 5.5 | 5.5 |
|                     | g  | 8   | 8   | 8   | 8   | 8   | 8   |
|                     | g.1  | 2   | 2   | 2   | 2   | 2   | 2   |
|                     | h  | 89  | 96  | 101 | 103 | 103 | 110 |
|                     | k  | 39  | 34  | 33  | 53  | 53  | 41  |
|                     | l min.   | 57  | 64  | 70  | 78  | 78  | 78  |
|                     | l max.   | 78  | 78  | 78  | 78  | 78  | 78  |
|                     | Terminal for cond. cross section (mm²) min.-max. | 1.5 | 1.5 | 1.5 | 2.5 | 2.5 | 2.5 |
|                     |  | -4  | -4  | -4  | -10 | -10 | -10 |