

Panel mounted inlet

Part no. 384



Technical specifications

Ampere	32 A
Poles	4 p
Voltage	230 V
Clock position	9 h
Hertz	50-60 Hz
Connection technology	Screw terminals
Contact	standard
Protection type	IP 44
Weight	245 g
Declaration of Conformity	VDE

Drawing

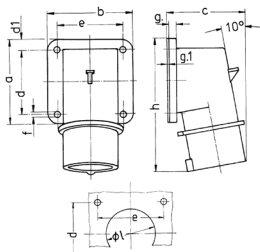

Drawing 2 MB 73 Dim. in mm	Amp. Poles	16		32		
		4	5	3	4	5
a		85	85	75	75	75
b		85	85	90	90	90
c		75	79	87	87	90
d		64	64	45	45	45
d1		10	10	13	13	13
e		64	64	78	78	78
f		5.5	5.5	5.5	5.5	5.5
g		6	6	6	6	6
g.1		2	2	2	2	2
h		129	129	137	137	138
l		50	50	55	55	55
Terminal for cond. cross section (mm ²) min.-max.		1	1	2.5	2.5	2.5
		-2.5	-2.5	-6	-6	-6