

Cepex panel mounted receptacle SCHUKO®

Part no. 4984



- alpine white or pearl white
- screw terminals
- suitable for installation in cable ducts and columns
- meeting DIN 18032 standards for ball rebound

Technical specifications

| | |
|---------------------------|----------|
| Ampere | 16 A |
| Poles | 2 p+E |
| Voltage | 230 V |
| Hertz | 50-60 Hz |
| Protection type | IP 44 |
| Shutter | false |
| Weight | 143 g |
| Declaration of Conformity | EAC |

Drawing

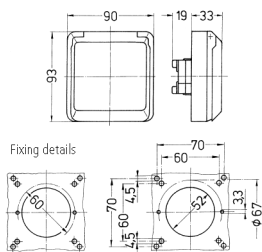

Drawing
1 MB 304
Dim. in mm