

**Plug**  
Part no. 638A



- screw terminals
- with grommet

**Technical specifications**

|                           |                 |
|---------------------------|-----------------|
| Ampere                    | 16 A            |
| Poles                     | 3 p             |
| Voltage                   | 20-25, 40-50 V  |
| Clock position            | 4 h             |
| Hertz                     | 100-200 Hz      |
| Connection technology     | Screw terminals |
| Contact                   | standard        |
| Protection type           | IP 44           |
| Weight                    | 153 g           |
| Declaration of Conformity | EAC, CQC        |

**Drawing**

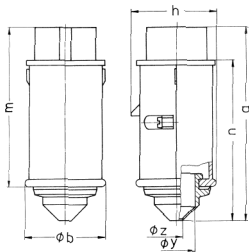

| Drawing<br>2 MB 159                  | Amp.<br>Poles | 16  |     | 32  |     |
|--------------------------------------|---------------|-----|-----|-----|-----|
|                                      |               | 2   | 3   | 2   | 3   |
| Dim. in mm                           | a             | 130 | 130 | 130 | 130 |
|                                      | b             | 55  | 55  | 55  | 55  |
|                                      | h             | 58  | 58  | 58  | 58  |
|                                      | m             | 108 | 108 | 108 | 108 |
|                                      | n             | 107 | 107 | 107 | 107 |
|                                      | y             | 25  | 25  | 25  | 25  |
|                                      | z             | 9   | 9   | 9   | 9   |
| Terminal for cond. cross             |               | 4   | 4   | 4   | 4   |
| section (mm <sup>2</sup> ) min.-max. |               | -10 | -10 | -10 | -10 |