

**Connector**  
Part no. 700A



- screw terminals with grommet

**Technical specifications**

Ampere	32 A
Poles	2 p
Voltage	50 V
Clock position	10 h
Connection technology	Screw terminals
Contact	standard
Protection type	IP 44
Weight	186 g
Declaration of Conformity	EAC, CQC

**Drawing**

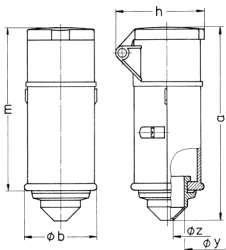

Drawing 3 MB 37	Amp. Poles	16		32	
		2	3	2	3
Dim. in mm	a	144	144	144	144
	b	55	55	55	55
	h	67	67	67	67
	m	122	122	122	122
	y	25	25	25	25
	z	9	9	9	9
Terminal for cond. cross section (mm <sup>2</sup> ) min.-max.		4	4	4	4
		-10	-10	-10	-10