

Panel mounted inlet

Part no. 752



- screw terminals
- highly heat resistant contact carrier
- nickel plated contacts

Technical specifications

| | |
|---------------------------|---|
| Ampere | 32 A |
| Poles | 7 p |
| Voltage | 400 V |
| Clock position | 6 h |
| Hertz | 50-60 Hz |
| Connection technology | Screw terminals |
| Contact | nickel plated contacts, highly heat resistant contact carrier |
| Protection type | IP 44 |
| Weight | 282 g |
| Declaration of Conformity | EAC, CQC |

Drawing

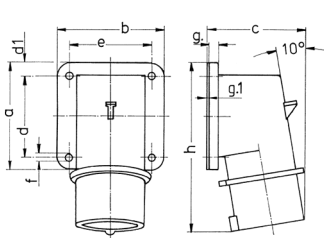

| Drawing | Amp. | 16 | 32 |
|---|-------|-----------|-----------|
| 2 MB 71 | Poles | 7 | 7 |
| Dim. in mm | a | 85 | 75 |
| | b | 85 | 90 |
| | c | 79 | 90 |
| | d | 64 | 45 |
| | d1 | 10 | 13 |
| | e | 64 | 78 |
| | f | 5.5 | 5.5 |
| | g- | 6 | 6 |
| | g.1 | 2 | 2 |
| | h | 129 | 138 |
| Terminal for cond. cross section (mm ²) min.-max. | | 1 -2.5 | 2.5 -6 |