

Panel mounted receptacle

Part no. 858



- screw terminals
- small flange dimensions
- 20° inclination

Technical specifications

| | |
|---------------------------|-----------------|
| Ampere | 16 A |
| Poles | 3 p |
| Voltage | 110 V |
| Clock position | 4 h |
| Hertz | 50-60 Hz |
| Connection technology | Screw terminals |
| Contact | standard |
| Protection type | IP 44 |
| Flange | 68x62 mm |
| Fixing hole | 47x47 mm |
| Inclination | 20 ° |
| Weight | 122 g |
| Declaration of Conformity | VDE |

Drawing

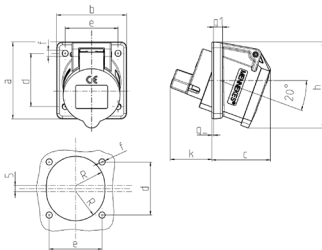

| Drawing | Amp. | 16 |
|---|-------|--------|
| 1 MB 472 | Poles | 3 |
| Dim. in mm | a | 68 |
| | b | 62 |
| | c | 52 |
| | d | 47 |
| | e | 47 |
| | f | 5.5 |
| | g. | 8 |
| | g.1 | 1.5 |
| | h | 76 |
| | k | 37 |
| Terminal for cond. cross section (mm ²) min.-max. | | 1.5 —4 |