

## AMAXX® receptacle combination

Part no. 950034



- pre-wired for installation
- hinged to the side
- enclosure and insert made of AMAPLAST
- fusing behind a transparent cover

## Technical specifications

CEE 16 A, 4 p, 400 V DUO	2
CEE 16 A, 3 p, 230 V DUO	2
Fusing	<ul style="list-style-type: none"> <li>• 2 MCB's 16 A, 3 p, C</li> <li>• 2 MCB's 16 A, 1 p+N, C</li> </ul>
Connection / feeder cable	<ul style="list-style-type: none"> <li>• for 2 cables up to 5 x 25 mm<sup>2</sup></li> </ul>
Protection type	IP 67
Shutter	false
Enclosure material	Plastic
Weight	7200 g
Height	650 mm
Width	225 mm

## Drawing

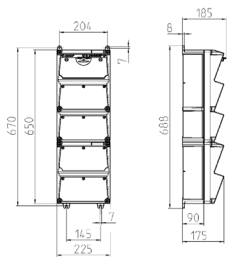

Drawing 1 MB 540

Depth dimensions at various fittings.

Receptacles	Degrees	Depth
SCHUKO® 16A, 230 V	IP 44	186 mm
	IP 67	208 mm
CEE 16A, 3p, 230V	IP 44	216 mm
	IP 67	220 mm
CEE 16A, 5p, 400V	IP 44	222 mm
	IP 67	226 mm
CEE 32A, 5p, 400V	IP 44	231 mm
	IP 67	236 mm
CEE 63A, 5p, 400V	IP 44	260 mm
	IP 67	260 mm

Cable entries: closed for cut out. 2 x M 40 each on top and bottom, 2 x M 20 each on top and bottom for cut out.