

## Panel mounted receptacle

Part no. 203A



- flange 63 A: 110 x 106 mm, inclination 20°
- flange 125 A: 114 x 110 mm, inclination 15°
- [X-CONTACT](#)

## Technical specifications

Ampere	63 A
Poles	4 p
Voltage	110 V
Clock position	4 h
Hertz	50-60 Hz
Connection technology	Screw terminals
Contact	X-CONTACT®
Protection type	IP 67
Flange	110x106 mm
Fixing hole	85x77 mm
Inclination	20 °
Weight	607 g
Declaration of Conformity	VDE, EAC, CQC

## Drawing

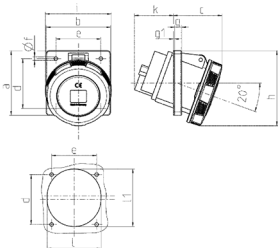

Drawing 1 MB 298	Amp. Poles	63		
		3	4	5
Dim. in mm	a	110	110	110
	b	106	106	106
	c	85	85	85
	d	85	85	85
	e	77	77	77
	f	6,2	6,2	6,2
	g	12	12	12
	g1	2	2	2
	h	128	128	128
	i	113	113	113
	k	67	67	67
	l	92	92	92
	l1	98	98	98
Terminal for cond. cross section (mm <sup>2</sup> ) min.-max.		6	6	6
		-25	-25	-25