

Panel mounted receptacle TM

Part no. 22189A



- screw terminals
- **X-CONTACT**
- highly heat resistant contact carrier
- nickel plated contacts
- 15° inclination
- (form BS)

Technical specifications

Ampere	125 A
Poles	5 p
Voltage	400 V
Clock position	6 h
Hertz	50-60 Hz
Connection technology	Screw terminals
Contact	highly heat resistant contact carrier, nickel plated contacts, X-CONTACT®
Protection type	IP 67
Flange	114x110 mm
Fixing hole	90x90 mm
Inclination	15 °
Weight	1232 g
Declaration of Conformity	VDE, EAC

Drawing

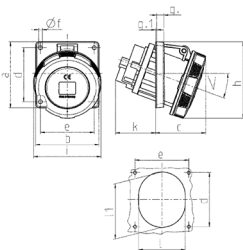

Drawing 1 MB 601	Amp. Poles	63				125			
		5	3	4	5	5	3	4	5
Dim. in mm	a	110	114	114	114	110	110	110	110
	b	106	110	110	110	110	110	110	110
	c	84	75	75	75	75	75	75	75
	d	90	90	90	90	90	90	90	90
	e	90	90	90	90	90	90	90	90
	f	6.5	6.2	6.2	6.2	6.2	6.2	6.2	6.2
	g	12	13	13	13	13	13	13	13
	g.1	2	2	2	2	2	2	2	2
	h	128	133	133	133	133	133	133	133
	i	113	126	126	126	126	126	126	126
	k	67	103	103	103	103	103	103	103
	l	92	94	94	94	94	94	94	94
	lt	98	107	107	107	107	107	107	107
	<	15°	15°	15°	15°	15°	15°	15°	15°
	Terminal for cond. cross section (mm ²) min.-max.	6	25	25	25	25	25	25	25
		-20	-70	-70	-70	-70	-70	-70	-70