

Panel mounted receptacle

Part no. 3192



- screw terminals
- 20° inclination
- receptacles optional fitted with auxiliary contact

Technical specifications

| | |
|---------------------------|-----------------|
| Ampere | 32 A |
| Poles | 5 p |
| Voltage | 50-500 V |
| Clock position | 10 h |
| Hertz | 100-300 Hz |
| Connection technology | Screw terminals |
| Contact | standard |
| Protection type | IP 44 |
| Flange | 100x92 mm |
| Fixing hole | 85x77 mm |
| Inclination | 20 ° |
| Weight | 288 g |
| Declaration of Conformity | EAC, CQC |

Drawing

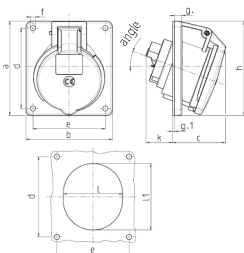

| Drawing 1 MB 260 Dim. in mm | Amp. Poles | 16 | | | 32 | | |
|--|---------------|------|-----|-----|-----|-----|-----|
| | | 3 | 4 | 5 | 3 | 4 | 5 |
| a | | 73.5 | 100 | 100 | 100 | 100 | 100 |
| b | | 64 | 92 | 92 | 92 | 92 | 92 |
| c | | 50 | 59 | 58 | 62 | 62 | 61 |
| d | | 60 | 85 | 85 | 85 | 85 | 85 |
| e | | 52 | 77 | 77 | 77 | 77 | 77 |
| f | | 5.5 | 5.5 | 5.5 | 5.5 | 5.5 | 5.5 |
| g | | 7 | 8 | 8 | 8 | 8 | 8 |
| g-1 | | 2 | 2 | 2 | 2 | 2 | 2 |
| h | | 79 | 100 | 100 | 103 | 103 | 106 |
| k | | 44 | 34 | 34 | 54 | 54 | 49 |
| l | | 52 | 55 | 65 | 67 | 67 | 72 |
| l1 | | 60 | 63 | 72 | 82 | 82 | 85 |
| α | | 20° | 20° | 20° | 20° | 20° | 20° |
| Terminal for cond. cross section (mm²) min.-max. | | 1.5 | 1.5 | 1.5 | 2.5 | 2.5 | 2.5 |
| | | -4 | -4 | -4 | -10 | -10 | -10 |