

## Panel mounted inlet

Part no. 383



## Technical specifications

|                           |                 |
|---------------------------|-----------------|
| Ampere                    | 32 A            |
| Poles                     | 4 p             |
| Voltage                   | 110 V           |
| Clock position            | 4 h             |
| Hertz                     | 50-60 Hz        |
| Connection technology     | Screw terminals |
| Contact                   | standard        |
| Protection type           | IP 44           |
| Weight                    | 245 g           |
| Declaration of Conformity | VDE             |

## Drawing

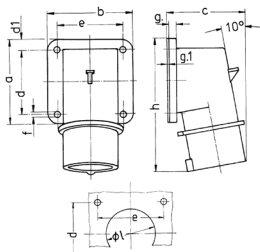

| Drawing<br>2 MB 73   | Amp.<br>Poles | 16   |      | 32  |     |     |
|--|---------------|------|------|-----|-----|-----|
|  |               | 4    | 5    | 3   | 4   | 5   |
| Dim. in mm   | a             | 85   | 85   | 75  | 75  | 75  |
|  | b             | 85   | 85   | 90  | 90  | 90  |
|  | c             | 75   | 79   | 87  | 87  | 90  |
|  | d             | 64   | 64   | 45  | 45  | 45  |
|  | d1            | 10   | 10   | 13  | 13  | 13  |
|  | e             | 64   | 64   | 78  | 78  | 78  |
|  | f             | 5.5  | 5.5  | 5.5 | 5.5 | 5.5 |
|  | g             | 6    | 6    | 6   | 6   | 6   |
|  | g.1           | 2    | 2    | 2   | 2   | 2   |
|  | h             | 129  | 129  | 137 | 137 | 138 |
|  | l             | 50   | 50   | 55  | 55  | 55  |
| Terminal for cond. cross<br>section (mm <sup>2</sup> ) min.-max. |               | 1    | 1    | 2.5 | 2.5 | 2.5 |
|  |               | -2.5 | -2.5 | -6  | -6  | -6  |