

Plug
Part no. 629A



- screw terminals with grommet

Technical specifications

Ampere	16 A
Poles	2 p
Voltage	20-25 V
Hertz	50-60 Hz
Connection technology	Screw terminals
Contact	standard
Protection type	IP 44
Weight	140 g
Declaration of Conformity	EAC

Drawing

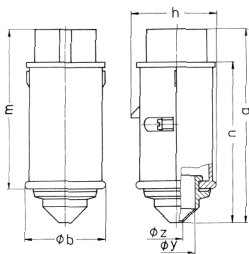

Drawing 2 MB 159	Amp. Poles	16		32	
		2	3	2	3
Dim. in mm	a	130	130	130	130
	b	55	55	55	55
	h	58	58	58	58
	m	108	108	108	108
	n	107	107	107	107
	y	25	25	25	25
	z	9	9	9	9
Terminal for cond. cross section (mm ²) min.-max.		4	4	4	4
		-10	-10	-10	-10