

Connector
Part no. 687A



- screw terminals with grommet

Technical specifications

| | |
|---------------------------|-----------------|
| Ampere | 16 A |
| Poles | 2 p |
| Voltage | 50 V |
| Clock position | 10 h |
| Connection technology | Screw terminals |
| Contact | standard |
| Protection type | IP 44 |
| Weight | 186 g |
| Declaration of Conformity | EAC, CQC |

Drawing

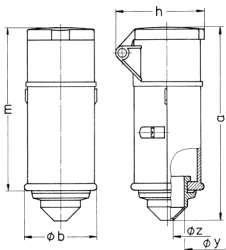

| Drawing 3 MB 37 | Amp. Poles | 16 | | 32 | |
|---|---------------|-----|-----|-----|-----|
| | | 2 | 3 | 2 | 3 |
| Dim. in mm | a | 144 | 144 | 144 | 144 |
| | b | 55 | 55 | 55 | 55 |
| | h | 67 | 67 | 67 | 67 |
| | m | 122 | 122 | 122 | 122 |
| | y | 25 | 25 | 25 | 25 |
| | z | 9 | 9 | 9 | 9 |
| Terminal for cond. cross section (mm ²) min.-max. | | 4 | 4 | 4 | 4 |
| | | -10 | -10 | -10 | -10 |