

## Connector

Part no. 75012

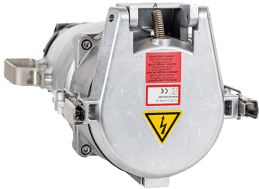

- aluminum enclosure
- Screw terminals
- with cable gland
- seawater resistant products are available on request
- if required, pilot cables can be introduced separately into plugs/ enclosures, please add „PK“ to the part number

## Technical specifications

Ampere	250 A
Poles	4 p
Voltage	500 V
Clock position	7 h
Hertz	50-60 Hz
Connection technology	Screw terminals
Contact	standard
Protection type	IP64
Weight	9774 g

## Drawing

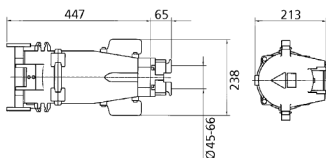

Drawing  
3 MB 54/1

Dim. in mm