

Built-in Plug
Part no. 8001



- screw terminals
- nickel plated contacts
- Lid: electric grey

Technical specifications

Ampere	16 A
Poles	3 p
Voltage	230 V
Clock position	6 h
Hertz	50-60 Hz
Connection technology	Screw terminals
Contact	nickel plated contacts
Protection type	IP 44
Weight	297 g
Declaration of Conformity	EAC

Drawing

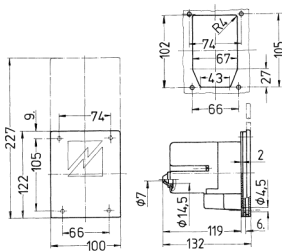

Drawing
2 MB 70
Dim. in mm