

**Built-in Plug**  
Part no. 8008



- screw terminals
- nickel plated contacts
- Lid: black

**Technical specifications**

Ampere	16 A
Poles	3 p
Voltage	230 V
Clock position	6 h
Hertz	50-60 Hz
Connection technology	Screw terminals
Contact	nickel plated contacts
Protection type	IP 44
Weight	293 g
Declaration of Conformity	EAC

**Drawing**

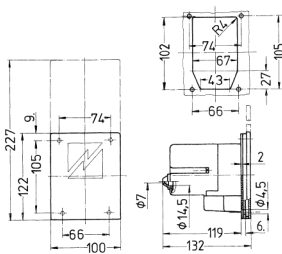

Drawing  
2 MB 70  
Dim. in mm