

## Panel mounted receptacle

Part no. 858



- screw terminals
- small flange dimensions
- 20° inclination

## Technical specifications

Ampere	16 A
Poles	3 p
Voltage	110 V
Clock position	4 h
Hertz	50-60 Hz
Connection technology	Screw terminals
Contact	standard
Protection type	IP 44
Flange	68x62 mm
Fixing hole	47x47 mm
Inclination	20 °
Weight	122 g

## Drawing

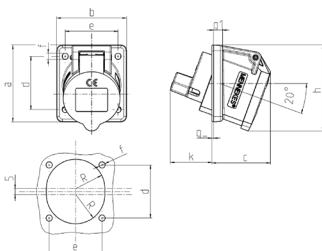

Drawing	Amp.	16
1 MB 472	Poles	3
Dim. in mm	a	68
	b	62
	c	52
	d	47
	e	47
	f	5,5
	g	8
	g-1	1,5
	h	76
	k	37
Terminal for cond. cross section (mm <sup>2</sup> ) min.-max.		1.5 - 4