

AMAXX® receptacle combination

Part no. 950031



- pre-wired for installation
- hinged to the side
- enclosure and insert made of AMAPLAST
- fusing behind a transparent cover

Technical specifications

| | |
|---------------------------|---|
| CEE 63 A, 5 p, 400 V | 1 |
| CEE 32 A, 5 p, 400 V | 1 |
| CEE 16 A, 5 p, 400 V | 1 |
| SCHUKO® 16 A, 230 V | 2 |
| Fusing | <ul style="list-style-type: none"> • 1 RCD 63 A, 4 p, 0.03 A • 1 MCB 32 A, 3 p, C • 1 MCB 16 A, 3 p, C • 2 MCB's 16 A, 1 p, C |
| Connection / feeder cable | • for 2 cables up to 5 x 25 mm ² |
| Protection type | IP 67 |
| Shutter | false |
| Enclosure material | Plastic |
| Weight | 8970 g |
| Height | 650 mm |
| Width | 225 mm |
| Declaration of Conformity | EAC |

Drawing

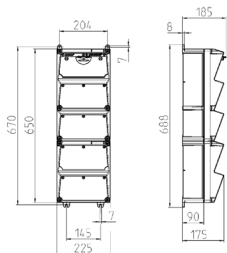

Drawing 1 MB 540

Depth dimensions at various fittings.

| Receptacles | Degrees | Depth |
|--------------------|---------|--------|
| SCHUKO® 16A, 230 V | IP 44 | 186 mm |
| | IP 67 | 208 mm |
| CEE 16A, 3p, 230V | IP 44 | 216 mm |
| | IP 67 | 220 mm |
| CEE 16A, 5p, 400V | IP 44 | 222 mm |
| | IP 67 | 226 mm |
| CEE 32A, 5p, 400V | IP 44 | 231 mm |
| | IP 67 | 236 mm |
| CEE 63A, 5p, 400V | IP 44 | 260 mm |
| | IP 67 | 260 mm |

Cable entries: closed for cut out. 2 x M 40 each on top and bottom, 2 x M 20 each on top and bottom for cut out.