

## Panel mounted receptacle with TwinCONTACT

Part no. 1739



- screwless spring terminals
- suitable for through wiring
- 20° inclination
- receptacles are designed for adding an auxiliary contact switch

### Technical specifications

|                       |                         |
|-----------------------|-------------------------|
| Ampere                | 32 A                    |
| Poles                 | 4 p                     |
| Voltage               | 230 V                   |
| Clock position        | 9 h                     |
| Hertz                 | 50-60 Hz                |
| Connection technology | Screwless - TwinCONTACT |
| Contact               | standard                |
| Protection type       | IP44                    |
| Flange                | 100x92 mm               |
| Fixing hole           | 85x77 mm                |
| Inclination           | 20 °                    |
| Weight                | 229 g                   |

### Drawing

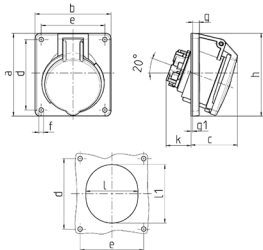

| Drawing<br>1 MB 465  | Amp.<br>Poles | 16   |     |     | 32  |     |     |
|--|---------------|------|-----|-----|-----|-----|-----|
|  |               | 3    | 4   | 5   | 3   | 4   | 5   |
| Dim. in mm   | a             | 73.5 | 100 | 100 | 100 | 100 | 100 |
|  | b             | 64   | 92  | 92  | 92  | 92  | 92  |
|  | c             | 52   | 58  | 58  | 61  | 61  | 60  |
|  | d             | 60   | 85  | 85  | 85  | 85  | 85  |
|  | e             | 52   | 77  | 77  | 77  | 77  | 77  |
|  | f             | 5.5  | 5.5 | 5.5 | 5.5 | 5.5 | 5.5 |
|  | g             | 7    | 8   | 8   | 8   | 8   | 8   |
|  | g-1           | 2    | 2   | 2   | 2   | 2   | 2   |
|  | h             | 79   | 100 | 100 | 103 | 103 | 105 |
|  | k             | 31   | 31  | 31  | 44  | 44  | 54  |
|  | l             | 52   | 55  | 65  | 70  | 70  | 73  |
|  | l1            | 60   | 63  | 72  | 82  | 82  | 85  |
| Terminal for cond. cross<br>section (mm <sup>2</sup> ) min.-max. |               | 1.5  | 1.5 | 1.5 | 2.5 | 2.5 | 2.5 |
|  |               | -4   | -4  | -4  | -6  | -6  | -6  |