

## Panel mounted receptacle with TwinCONTACT

Part no. 1740



- screwless spring terminals
- suitable for through wiring
- 20° inclination
- receptacles are designed for adding an auxiliary contact switch

### Technical specifications

Ampere	32 A
Poles	4 p
Voltage	400 V
Clock position	6 h
Hertz	50-60 Hz
Connection technology	Screwless - TwinCONTACT
Contact	standard
Protection type	IP44
Flange	100x92 mm
Fixing hole	85x77 mm
Inclination	20 °
Weight	236 g
Certifications	VDE

### Drawing

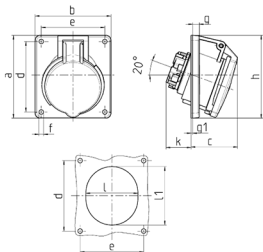

Drawing 1 MB 465 Dim. in mm	Amp. Poles	16			32		
		3	4	5	3	4	5
a	73.5	100	100	100	100	100	
b	64	92	92	92	92	92	
c	52	58	58	61	61	60	
d	60	85	85	85	85	85	
e	52	77	77	77	77	77	
f	5.5	5.5	5.5	5.5	5.5	5.5	
g	7	8	8	8	8	8	
g-1	2	2	2	2	2	2	
h	79	100	100	103	103	105	
k	31	31	31	44	44	54	
l	52	55	65	70	70	73	
l1	60	63	72	82	82	85	
Terminal for cond. cross section (mm <sup>2</sup> ) min.-max.	1.5	1.5	1.5	2.5	2.5	2.5	
	-4	-4	-4	-6	-6	-6	