

Panel mounted receptacle

Part no. 3036



- screw terminals
- uniform flange dimensions
- 20° inclination
- receptacles are designed for adding an auxiliary contact switch

Technical specifications

| | |
|-----------------------|-----------------|
| Ampere | 16 A |
| Poles | 3 p |
| Voltage | 230 V |
| Clock position | 6 h |
| Hertz | 50-60 Hz |
| Connection technology | Screw terminals |
| Contact | standard |
| Protection type | IP44 |
| Flange | 85x85 mm |
| Fixing hole | 70x70 mm |
| Inclination | 20 ° |
| Weight | 148 g |
| Certifications | VDE |

Drawing

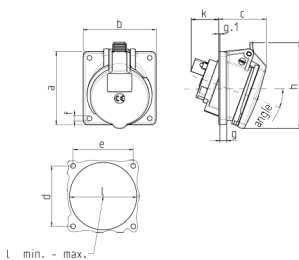

| Drawing 1 MB 453 | Amp. Poles | 16 | | | 32 | | |
|---------------------|---|-----|-----|-----|-----|-----|-----|
| | | 3 | 4 | 5 | 3 | 4 | 5 |
| Dim. in mm | a | 85 | 85 | 85 | 85 | 85 | 85 |
| | b | 85 | 85 | 85 | 85 | 85 | 85 |
| | c | 53 | 57 | 57 | 60 | 60 | 67 |
| | d | 70 | 70 | 70 | 70 | 70 | 70 |
| | e | 70 | 70 | 70 | 70 | 70 | 70 |
| | f | 5.5 | 5.5 | 5.5 | 5.5 | 5.5 | 5.5 |
| | g | 8 | 8 | 8 | 8 | 8 | 8 |
| | g.1 | 2 | 2 | 2 | 2 | 2 | 2 |
| | h | 89 | 96 | 101 | 103 | 103 | 110 |
| | k | 39 | 34 | 33 | 53 | 53 | 41 |
| | l min. | 57 | 64 | 70 | 78 | 78 | 78 |
| | l max. | 78 | 78 | 78 | 78 | 78 | 78 |
| | Terminal for cond. cross section (mm²) min-max. | 1.5 | 1.5 | 1.5 | 2.5 | 2.5 | 2.5 |
| | | -4 | -4 | -4 | -10 | -10 | -10 |