

Cepex grounding-type flush mounted receptacle

Part no. 4902



- french-belgian standard
- screw terminals
- with flush mounted installation box
- meeting DIN 18032 standards for ball rebound

Technical specifications

| | |
|-----------------|----------|
| Ampere | 16 A |
| Poles | 2 p+PE |
| Voltage | 230 V |
| Hertz | 50-60 Hz |
| Protection type | IP44 |
| Shutter | true |
| Weight | 230 g |

Drawing

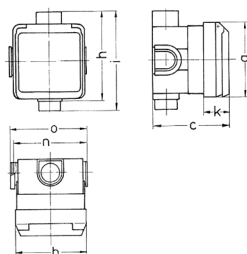

| Drawing 1 MB 336 | Amp. Poles | 16 | | | 32 | | |
|--|---------------|-----|-----|-----|-----|-----|-----|
| | | 3 | 4 | 5 | 3 | 4 | 5 |
| Dim. in mm | a | 93 | 93 | 93 | 93 | 93 | 93 |
| | b | 90 | 90 | 90 | 90 | 90 | 90 |
| | c | 95 | 95 | 95 | 95 | 95 | 95 |
| | h | 111 | 111 | 111 | 111 | 111 | 111 |
| | i | 124 | 124 | 124 | 124 | 124 | 124 |
| | k | 33 | 33 | 33 | 33 | 33 | 33 |
| | n | 91 | 91 | 91 | 91 | 91 | 91 |
| | o | 95 | 95 | 95 | 95 | 95 | 95 |
| Terminal for cond. cross section (mm ²) min.-max. | | 1.5 | 1.5 | 1.5 | 2.5 | 2.5 | 2.5 |
| | | -4 | -4 | -4 | -6 | -6 | -6 |