

# Wall mounted inlet

Part number: 75338

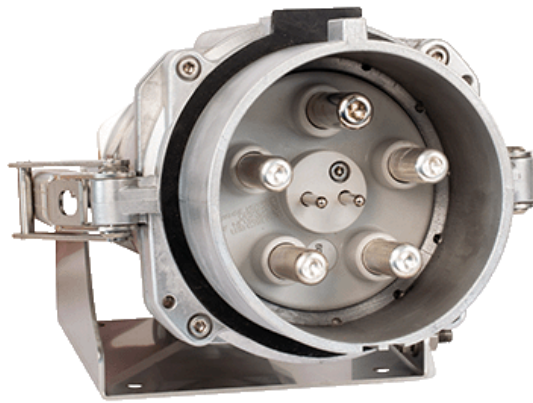

**MENNEKES**  
Elektrotechnik GmbH & Co. KG

Aloys-Mennekes-Straße 1  
57399 Kirchhundem  
GERMANY

[www.MENNEKES.org](http://www.MENNEKES.org)

# Product Description

- highly heat resistant contact carrier, nickel plated contacts
- external fixing
- 10° inclination
- MetalLine
- aluminium enclosure
- seawater resistant products are available on request

# Technical Details

Wall mounted inlet	75338
Ampere	600A
Number of poles	4p
Clock position	6h
Nominal voltage AC	400V
Nominal frequency	50 - 60 Hz
Protection type IP	IP67
Contact carrier	highly heat resistant contact carrier, nickel plated contacts
Connection	cage terminals
Tightening torque connection terminal	allen key
Phase inverter	without phase inverter
Pilot contact	2 pilot contacts
Blind cable entry at the rear	no
Enclosure base can be turned 180°	no
Insertion direction	angled
Inclination	10°
Type of mounting	external fixing
Military version	no
Protection cap	without protection cap
Tightening torque connection terminal	8 Nm
Recommended wire end treatment for supply cable connection terminal	usable with and without ferrule
Strip length jacket	200 mm
Conductor cross-section min.	150 mm <sup>2</sup>
Conductor cross-section max.	300 mm <sup>2</sup>

Wall mounted inlet	75338
Conductor cross-section pilot max.	4 mm <sup>2</sup>
Weight (net)	10000 g
Packaging unit	1 Stück
Quantity per pallet	48 Stück
EAN / identification number	4015394000143

Permissible ambient conditions

	Min.	Max.
Permanent ambient temperature	-40 °C	80 °C

Material properties

Housing	aluminium grey [no RAL colour code]
External screws	bare stainless steel

Material resistance

The material resistance overview can be found on the website in the section “Knowledge” - “Product knowledge” - “Materials”.

Material and environmental properties

RoHS 2011/65/EU incl. 2015/863/EU	✓
POP regulation (EU) 2019/1021	✓
Halogen-free	yes

Regulations and Standards

Norm	DIN EN IEC 60309
Declaration of Conformity	CE

# Dimensional Drawing

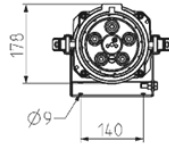
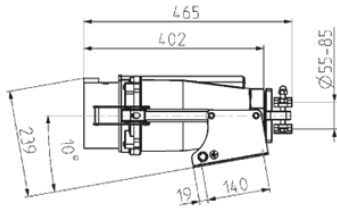

Drawing  
2 MB 272

Dim. in mm

