

Wall mounted inlet

Part no. 846



- screw terminals
- with hinged lid
- for internal or external fixing

Technical specifications

Ampere	16 A
Poles	3 p
Voltage	110 V
Clock position	4 h
Hertz	50-60 Hz
Connection technology	Screw terminals
Contact	standard
Protection type	IP 44
Weight	140 g
Declaration of Conformity	DE,VDE, CN,CQC

Drawing

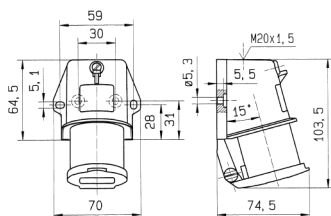

Drawing
2 MB 212

Dim. in mm